



More than a location,
a great destination.



eventlounge.be

info@eventlounge.be
+32 (0)2 726 55 26

Bd. Général Wahislaan
16F, 1030 Brussels



Share.
Connect.
Learn.

eventlounge.be

Menu

All in one concept	6
Plans	8
Event facilities	12
Catering partners	17
Technical partners	19
Hotel partners	20
A great location & Click to discover our other venues in town	23

All in one concept

Event Lounge is a venue with a trendy and glamorous style, offering you an “all in one” concept package for your events and corporate events: rooms equipped with the most modern audio and video technology, a modular set-up, high-level catering, as well as an experienced and dynamic coordination team.

The originality, modularity and flexibility of Event Lounge allows you to organize a staff party, a product launch, a conference, a seminar, a hybrid event, a lavish gala, an awards ceremony & more.



At Event Lounge, you have
at hand all the support you need
to make your event **unforgettable.**

The **unlimited creativity** of
Event Lounge is the reason for
its forever growing **success.**

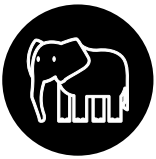

Event Lounge offers an infrastructure of 2500m² of Business & Event possibilities. This unique venue can host events from **40 up to 1150 guests** with his main room of **1250 m² and 11m height.**

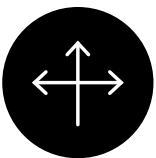

Event Lounge is easily accessible and situated not far from **the heart of Brussels & Brussels National Airport.** Event Lounge has a private parking of **150 cars** and parking facilities in the surroundings for **300 cars.**



Event Lounge cares about the environment and limits its CO² emissions wherever possible. In this respect, Event Lounge has signed the "**Green Key, ECO dynamic**" charter and has undertaken a series of steps to limit its ecological footprint.

Plans

Ground floor

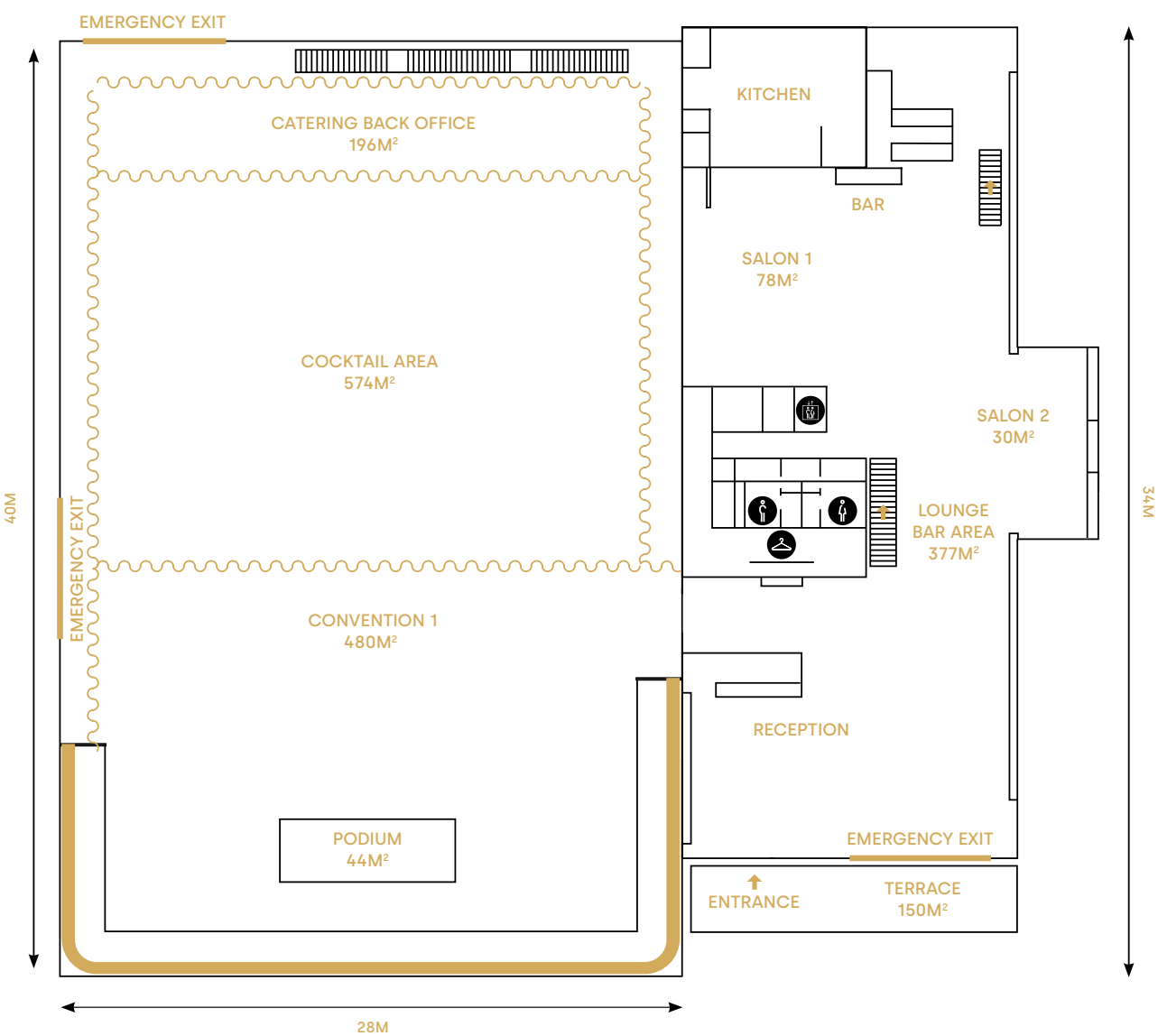

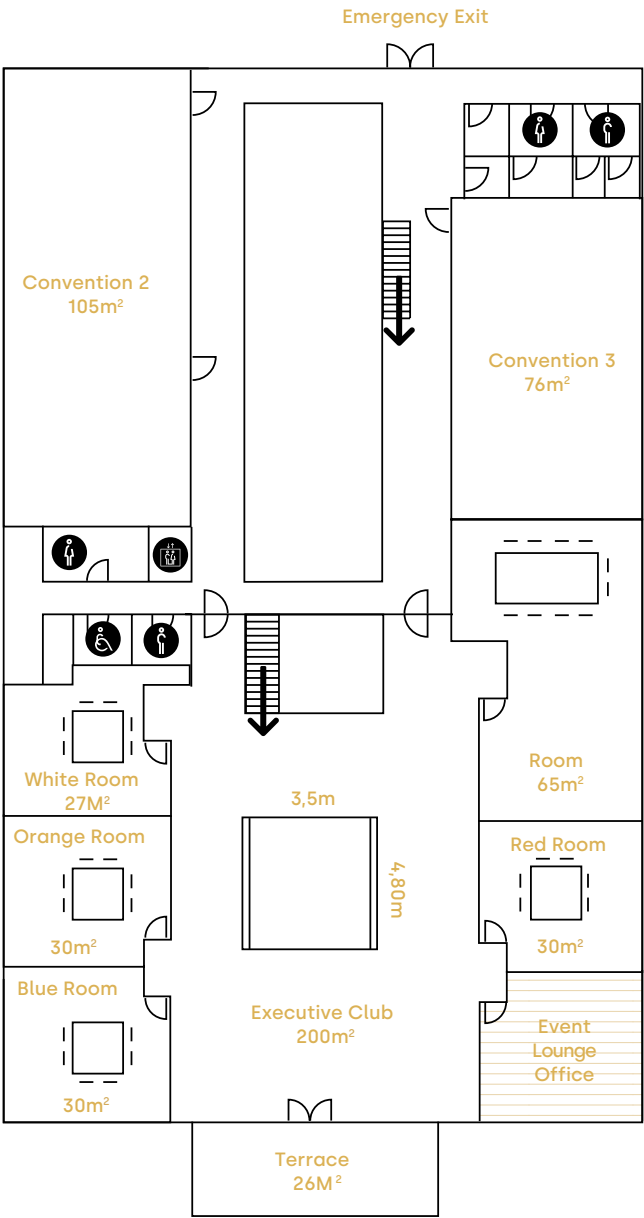

Plans

First floor





Event facilities



574 m²

600



450

320

500

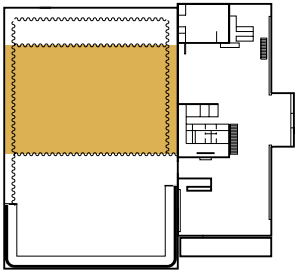

100

Ground floor





Cocktail area





480 m²

400



300

250

400

100

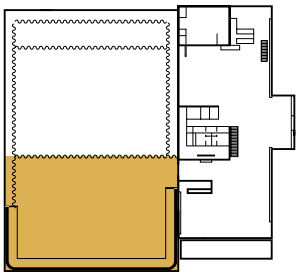
Ground floor





Convention 1





Event facilities



1250 m²

1000



750

570

900

200

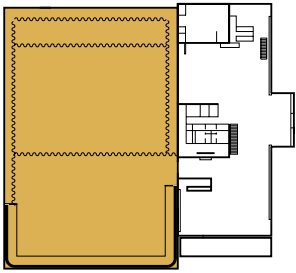
Ground floor



Studio: cocktail area & convention 1



150 - 400 m²

50 - 400

Ground floor

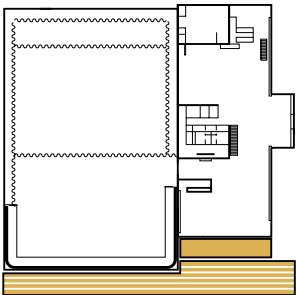

Terrace & outdoor





Event facilities

485 m²



450

150

100

100

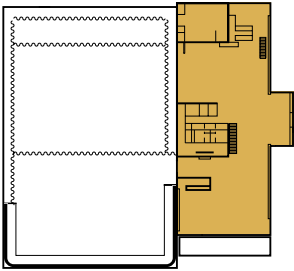
Ground floor



Lounge bar area & salon's





Event facilities

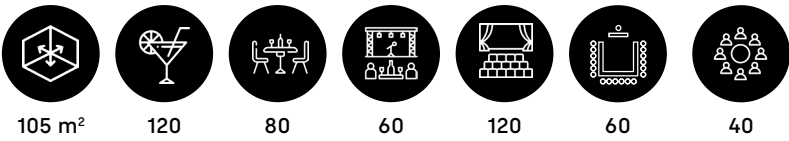

Level 1

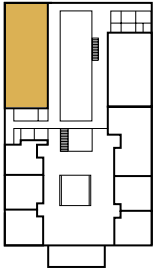

Convention 2

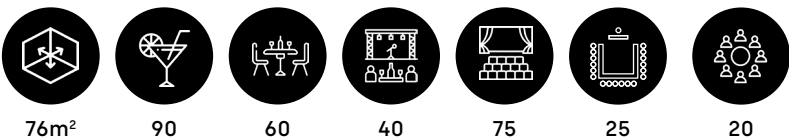

Level 1

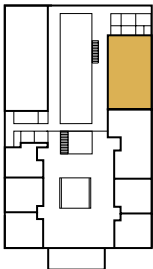

Convention 3



Event facilities

30 m²

20



8-12

65 m²

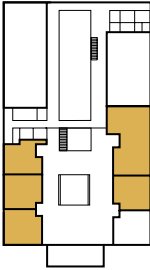

30

16-20

Level 1



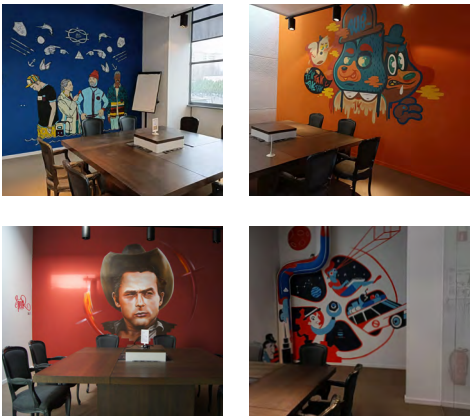

Meeting rooms





Executive room





200m²

150



80

60

80

25

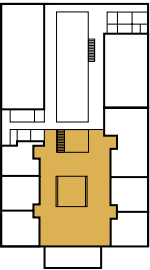
Level 1



Executive club







Memories. Network. Growth.

eventlounge.be

Catering partners

Great Traiteur

The innovative partner
for your dining experience.

Louis de Streel
louis@great.be
+32 (0)2 880 87 80
+32 (0)472 90 54 09
great-traiteur.be



For your event, every detail is important.

Great traiteur coordinates every aspect of it: products, equipment, service and staging. We are a professional team that leaves nothing to chance and adds the right touches of flavor that make the difference. Special care is given to the sourcing of your products.

We create menus meeting specific dietary requirements, incorporating.



J&M

Your secret ingredient.

Aïko Vanholder
aiko.vanholder@jmcatering.be
info@jmcatering.be
+32 (0)3 877 88 10
+32 (0)473 68 94 63
jmcatering.be



J&M has been active in event catering for private citizens and companies since 1992.

Our team of motivated and passionate employees guarantees a professional approach and strive for absolute perfection for every assignment. Authenticity and innovation go hand in hand at J&M.

Every budget has its prestige. With refined tastes and delirious decoration, we offer you and your guests an unforgettable experience.



Catering partners

Artfood

Christophe Vandenberghe

christophe@artfood.be

+32 (0)2 732 33 85

+32 (0)477 30 05 16

artfood.be



The cuisine of Artfood Traiteur is a combination of gastronomy, modernity, aesthetics and ethics.

Founded in 2009 Artfood Traiteur is a modern company that is driven by the notions of excellence, passion and creativity with a human and environmentally responsible vision.

Our company guarantees a unique approach to even the most exclusive and elegant receptions by offering refined menus.



Cœur Catering

Happy People Make
Great Food

Philippe Vanoverberghe

info@coeurcatering.be

+32 (0)9 277 92 72

coeurcatering.be



With 20 years of expertise, a creative mindset, and an eye for perfection, we craft refined cuisine under the motto "Happy People Make Great Food."

Our dishes are approachable yet surprising—classic or adventurous, always thoughtful. Sustainability is at our core: local and seasonal ingredients, fair partnerships, reduced waste, and positive social impact.

Awarded the Gault&Millau Sustainability Catering Award 2024 and proudly the first Belgian B Corp–certified caterer since 2025, Coeur Catering continues to innovate and connect people through food that truly matters.



Catering partners

Freddy met Curry

Appetite comes
with change

Benjamin Ceuppens

benjamin@freddymetcurry.be

+32 (0)456 04 29 69

freddymetcurry.be



A colourful cooking, 100% organic, made with local and seasonal products, where forgotten vegetables are finally rediscovered and their flavours enhanced tenfold. An original touch that combines simplicity and creativity to surprise without ever complicating. Freddy met Curry, the caterer who brings life to your events.



Technical partners

Laser System Europe

Creative technology

Laurent Rossion

+32 478 98 21 95

laurent@lse.be

lse.eu



Starting 13/02/2026, Laser System Europe (LSE) becomes our exclusive technical partner, bringing over 30 years of event-technology expertise. Known for integrating lasers, drones, water and special effects, lighting, and video, LSE has transformed venues worldwide.

Together, we are reinventing our technical infrastructure: a 180° cyclo screen powered by five Barco projectors will deliver fully immersive visuals, while a kinetic ceiling of 12 movable fixtures will reshape the room's volume—adapting seamlessly from open symposium settings to intimate gatherings or dynamic party atmospheres.



Hotel partners

Penta hotels Brussels City Centre

Reception Desk

+32 (0)2 533 66 66

info.brussels.center@pentahotels.com
pentahotels.com

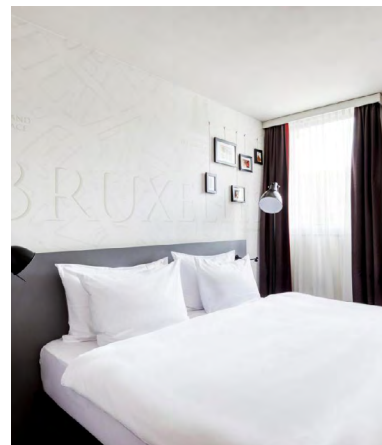

Gresham Belson Hotel Brussels

Reception Desk

+32 (0)2 708 31 00

resa@gresham-belsonhotel.com
gresham-hotels-brussels.com

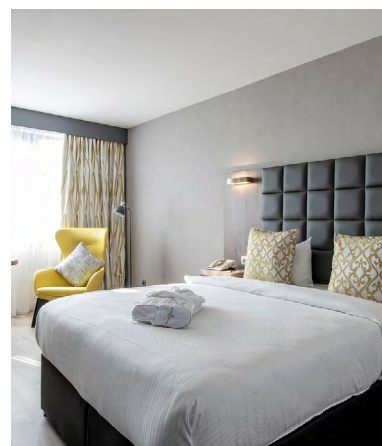

Hotel partners

Courtyard by Marriott Brussels Hotel

Reception Desk

+32 (0)2 708 31 00

christine.cornelis@marriott.com
[marriott.com](https://www.marriott.com)

COURTYARD[®]
BY MARRIOTT
Brussels

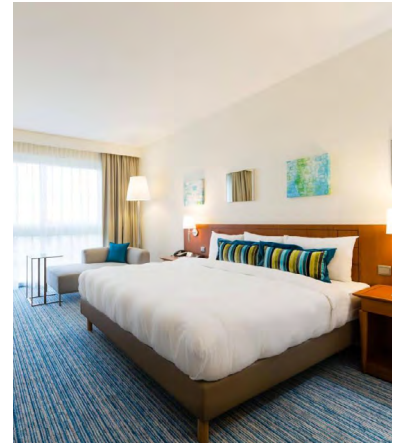

Martin's Brussels EU

Reception Desk

+32 (0)2 230 85 55

mbeu@martinshotels.com
[martinshotels.com](https://www.martinshotels.com)

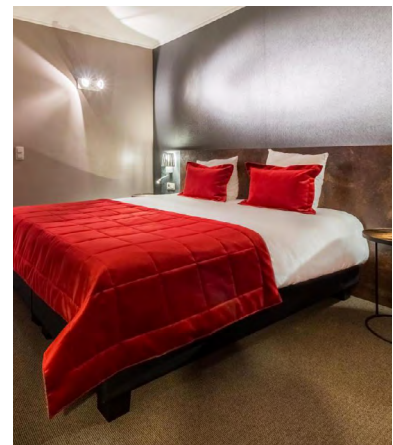



Inspire.
Experience.
Build.

eventlounge.be

A great location

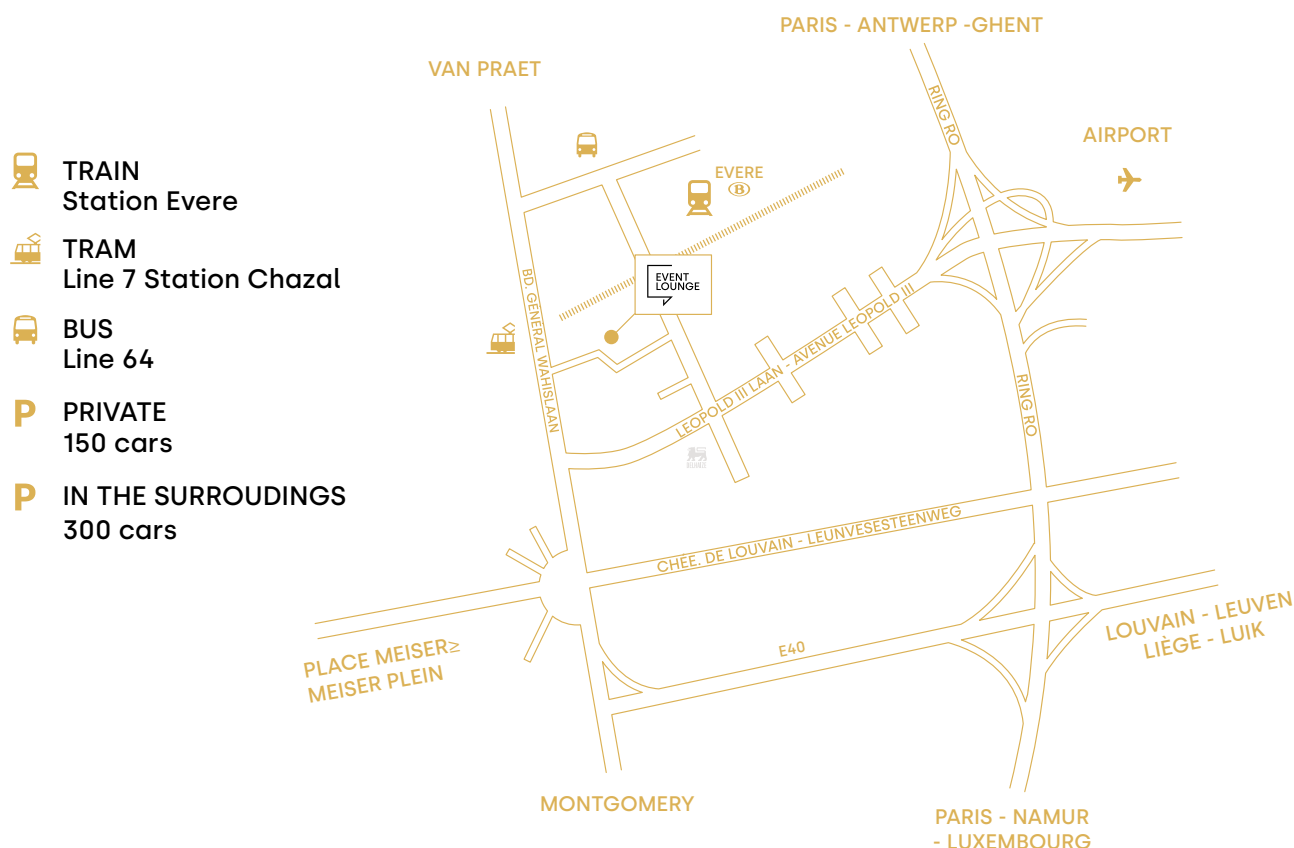

Click to discover our other venues in town



LES JEUX D'HIVER



eventlounge.be

info@eventlounge.be
+32 (0)2 726 55 26

Bd. Général Wahislaan
16F, 1030 Brussels