



Google Digital Atelier @BeCentral – Where Meetings **Meet AI**

We are delighted to announce that the Google Digital Atelier managed by dside for 2 years is now open for third parties as event, meeting or incentive space.

Contact us

Welcome to the Google Digital Atelier.

A central Brussels hub where AI inspires innovation.

Where AI Meets Collaboration and Ideas

Unleash innovation at the heart of Brussels. Nestled within Brussels Central Station, the Google Digital Atelier at BeCentral is more than just an event space—it's a hub where AI meets creativity, inspiration, and impact.

Once dedicated solely to digital training, this iconic venue now opens its doors as a premium event space for organizations looking to host unforgettable, AI-driven experiences.

Why choose the Google Digital Atelier ?

A Legacy of Innovation

Powered by Google and part of BeCentral's digital ecosystem, your event will engage a community of forward-thinking AI enthusiasts.

A Space That Inspires

The largest and most dynamic room in BeCentral is fully equipped for AI-focused conferences, workshops, and networking events that leave a lasting impact.

An Unmatched Location

Located directly inside Brussels Central Station, the venue ensures effortless accessibility for national and international guests.

A Unique Partnership

With Google as a key supporter, your event benefits from a space designed for creativity, digital excellence, and AI-powered collaboration.

Whether you're launching a product, hosting a corporate summit, or sparking AI-driven discussions, the Google Digital Atelier is where ideas take flight.



Meeting packages

[Extras](#)

Half day	Half day + Lunch	Full day
65,00 €	90,00 €	110,00 €
4h package 09:00 - 13:00 or 14:00 - 18:00 Extra hours on top of this package will be confirmed as full day	5h package 09:00 - 14:00 or 13:00 - 18:00 Extra hours on top of this package will be confirmed as full day	9h package 09:00 - 18:00 Extra hours on top of this package will be €10 per person / per hour
Venue rental • Breakfast Snacks • Drinks	Venue rental • Breakfast Snacks • Drinks • Lunch	Venue rental • Breakfast Snacks • Drinks • Lunch
Minimum amount of people - 25 pax This package includes a self-service concept		

Extras meeting packages

	Price	Comments
Project Manager outside office hours	€85/h	
Hostess outside office hours (min 4h)	€35/h	Obligated from 16:30
> 9h of event	€10/h/pers	
Furniture	On demand	
Technician	On demand	
Technical equipment	On demand	
Specific catering requests More high-level event catering	On demand	Requests with Great Traiteur

Floor Plan

[Plan 1](#)[Plan 2](#)

Our venue offers a variety of setup options to accommodate different event formats and sizes



200m²



100 pax

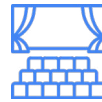

80 pax

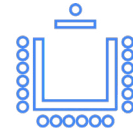

50 pax



Theater style



Cocktail/Walking Dinner



U-shape/Boardroom/Classroom/Round Table

Event Facilities : everything you need for a successful event

The Google Digital Atelier is equipped to ensure a seamless and successful event.



Audiovisual equipment

- Sound system
- 2 Handheld mics
- 2 Headset mics
- 110" Main screen (possibility to hide via sliding doors)
- Clicker
- 2 Comfort monitors (incl timer)
- 2 Fixed remote camera's
- Stage light & small kit atmosphere lights
- High-Speed Wi-Fi



Furniture

- 50 Chairs
- 20 Tabourets
- 3 movable tribunes (12 seats per tribune)
- 3 Round tables (fixed placement, coming from ceiling)
- 10 stage chairs for panels (5x beige, 5x green)

Location & Accessibility:

An iconic venue, in the heart of Brussels

The Google Digital Atelier is located on the 1st floor of BeCentral, situated in the Brussel Central Station.



A prime location in the Heart of Brussels

 Cantersteen 12, 1000 Brussels

 Interparking Albertina - Pl. de la Justice, 1000 Bruxelles

 Designed for inclusivity - Fully accessible for guests with reduced mobility.



Host your event in Brussels' **AI hub** – reserve your spot today!

Don't miss this unique opportunity
– open until March 2026

atelier@d-sidegroup.com

Plan 1

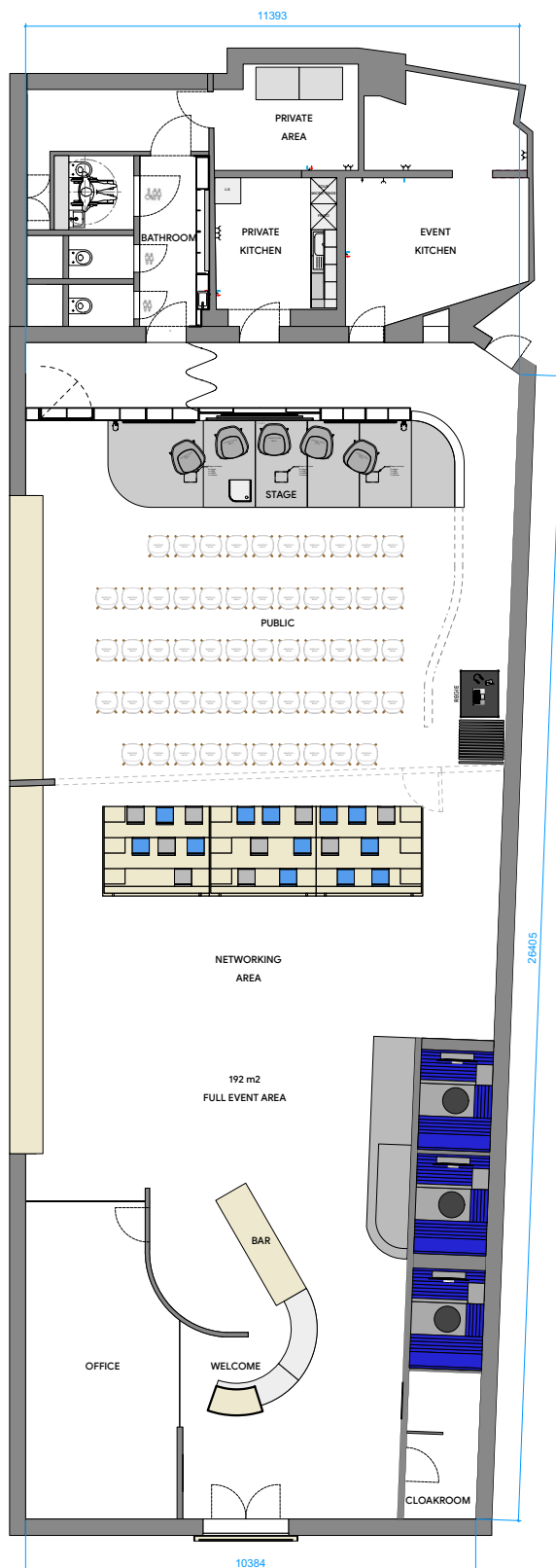

80 pax max
Theater style + networking area

Plan 2

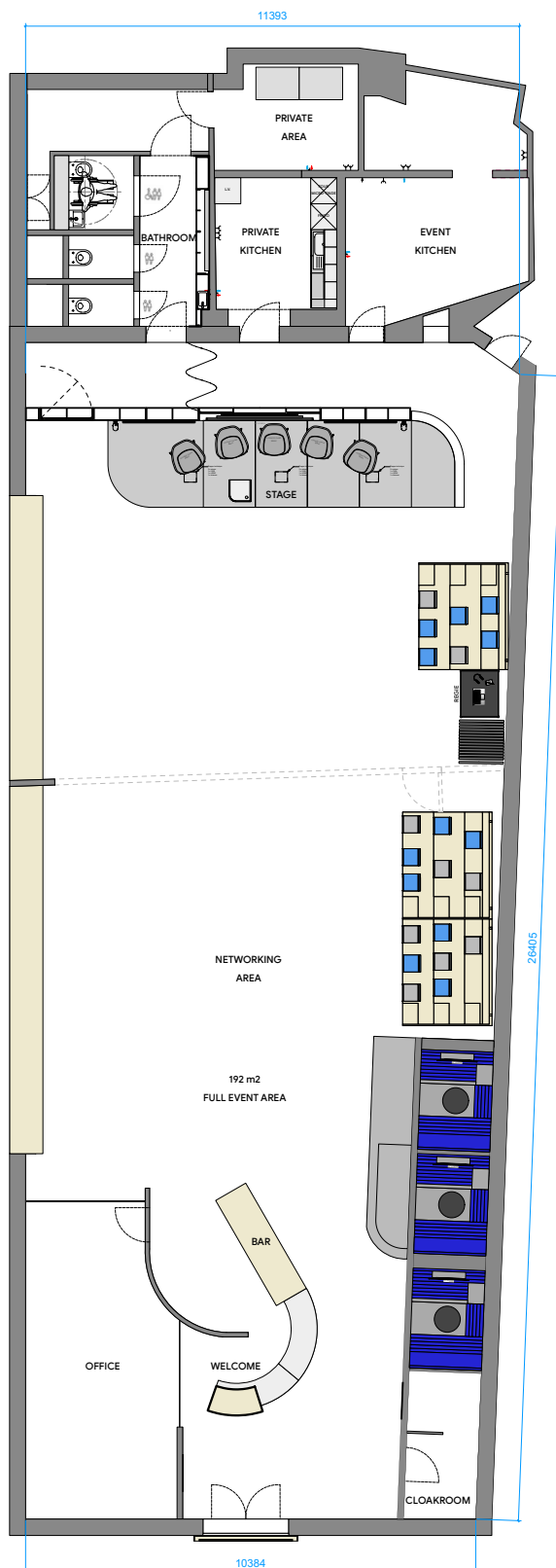

100 pax max
Open room